

BELLEX



LUXINTEC

MODELS

On three-phase track



TYPES OF LIGHTING

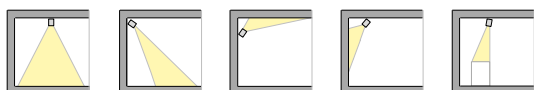

APPLICATION AREAS

Museums



Shop windows

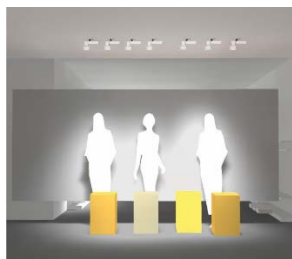

Interiors of shops



Supermarkets



Restaurants



Churchs



Historical buildings



Access halls



BELLEX with **DIAMOND** reflector

- **SURFTHERM** technology for optimised heatsink
- Optional:
 - Wireless dimming with App
- Up to L80B50 95,000 hours



Up to 131 lm/W

High efficiency **DIAMOND** reflector

BELLEX with **XQUARE OPTICS**

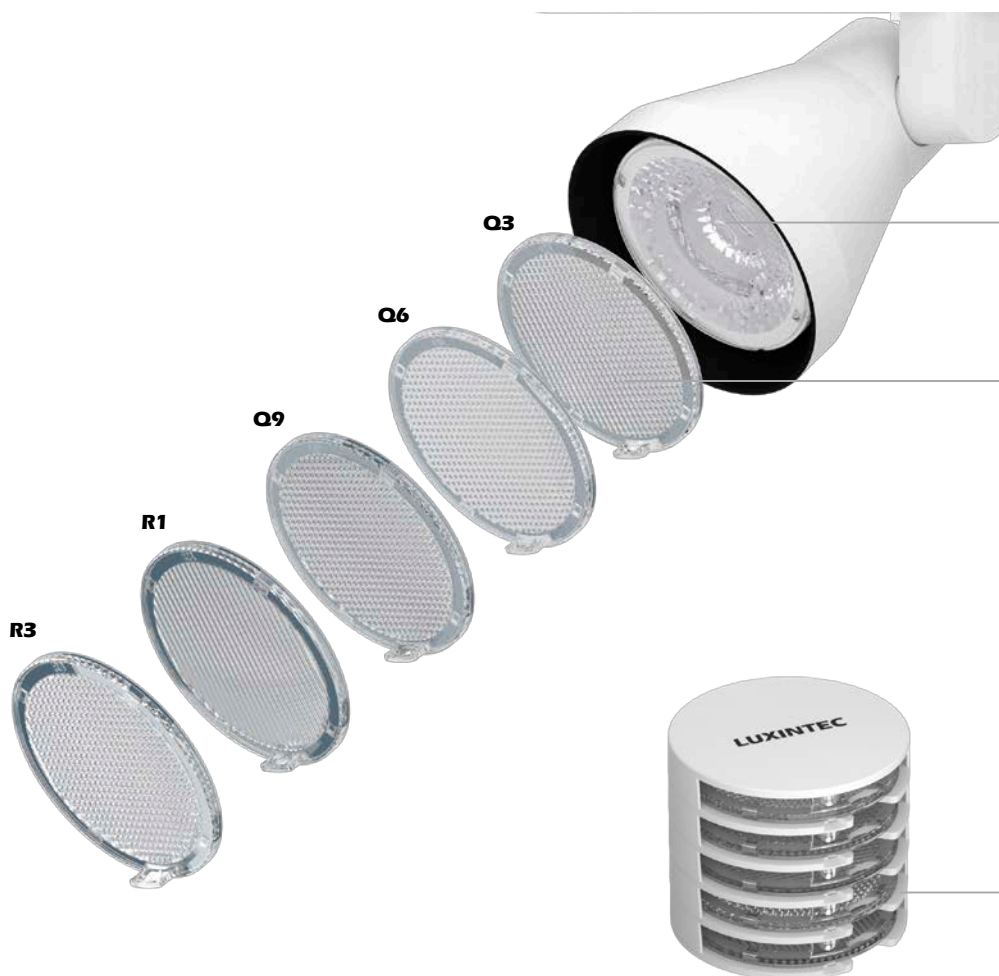

Up to 135 lm/W

XQUARE OPTICS

interchangeable
XQUARE OPTICS KIT

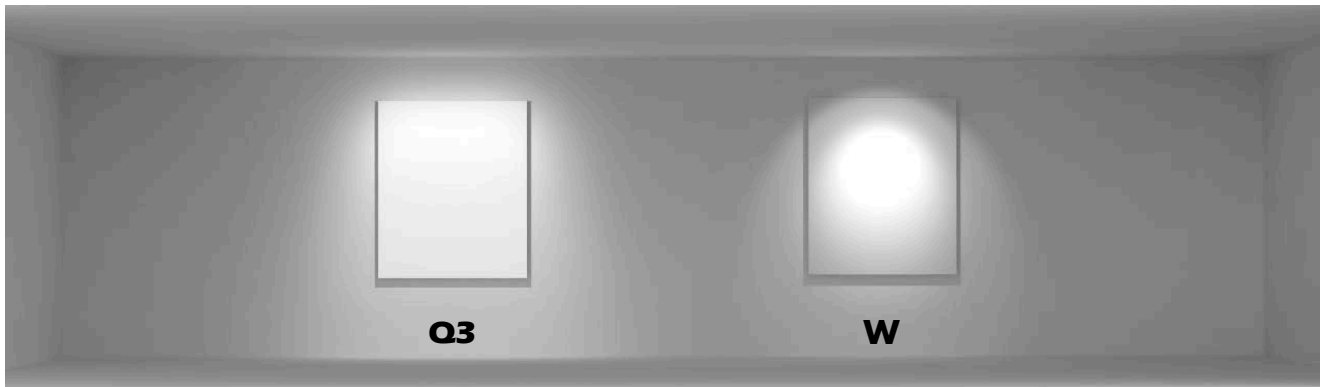

PHOTOMETRIES

XQUARE OPTICS S1 15°

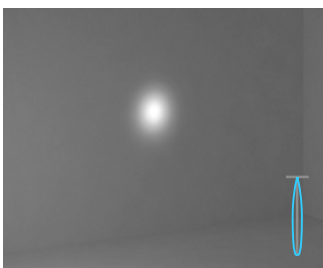

XQUARE OPTICS S2 20°



XQUARE OPTICS Q3 30° x 30°



XQUARE OPTICS Q6 60° x 60°

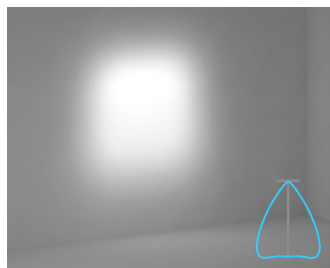

XQUARE OPTICS Q9 90° x 90°

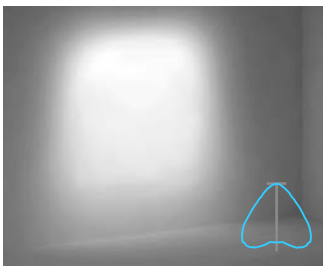

XQUARE OPTICS R1 15° x 90°

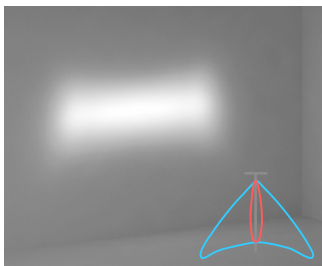

XQUARE OPTICS R3 30° x 90°

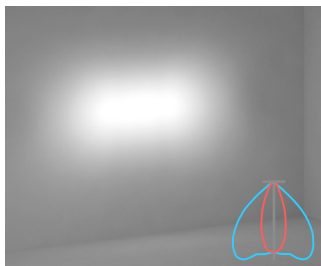

N 20°



M 29°



W 44°

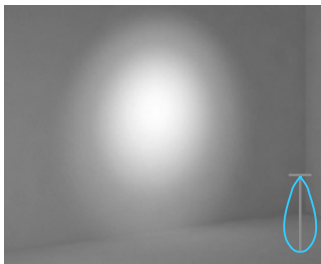

Isolux curves: — 0° - 180° — 90° - 270°

LUMINOUS FLUX

| VERSION | POWER RATING (W) | 2700K | | 3000K | | 4000K | |
|----------------------------|------------------|--------------------|----------------------------|--------------------|----------------------------|--------------------|----------------------------|
| | | LUMINOUS FLUX (lm) | LIGHTING EFFICIENCY (lm/W) | LUMINOUS FLUX (lm) | LIGHTING EFFICIENCY (lm/W) | LUMINOUS FLUX (lm) | LIGHTING EFFICIENCY (lm/W) |
| BELLEX S2 OPTICS | 18 | 2233 | 124 | 2311 | 128 | 2432 | 135 |
| | 27 | 2919 | 108 | 3020 | 112 | 3178 | 118 |
| BELLEX Q6 OPTICS | 18 | 1935 | 108 | 2003 | 111 | 2107 | 117 |
| | 27 | 2529 | 94 | 2617 | 97 | 2754 | 102 |
| BELLEX N OPTICS | 18 | 2159 | 120 | 2234 | 124 | 2350 | 131 |
| | 27 | 2821 | 104 | 2919 | 108 | 3072 | 114 |

Total luminaire luminous flux. Average values at 25°C ambient temperature with CRI 80+. Visit www.luxintec.com to obtain photometric files of all light colours available, see them in the reference coding table.

OTHER CHARACTERISTICS

| | |
|-------------------------------|---|
| MATERIALS | Aluminium with SURFTHERM technology in light engine housing and rotation arm High transmittance polymer in cover and XQUARE OPTICS diffusers |
| FINISHES | Metallised in reflectors High resistance powder coating in housing and rotation arm |
| LIGHT ENGINE SERVICE LIFE | 95,000 hours L80B50 83,000 hours L80B10 |
| DRIVER SERVICE LIFE | > 50,000 hours |
| OPERATING AMBIENT TEMPERATURE | -20°C up to 35°C |
| COLOUR CONSISTENCY SDCM | < 3 MacAdam ellipses |
| TYPE OF POWER FEED | 220-240VAC, 50..60Hz |
| WEIGHT | 0.7 Kg |

WEB PRODUCT CONFIGURATOR

REFERENCE CODING

| | REF. | DESCRIPTION | AVAILABLE FOR |
|--|----------------------|-----------------------------------|-----------------------------------|
| 01 | MODEL | BELLEX | |
| 02 | MOUNTING | T On three-phase track | |
| 03 | POWER RATING | 12 12W | All |
| | | 18 18W | |
| | | 27 27W | |
| 04 | ELECTRICAL EQUIPMENT | F Non-dimmable | All |
| | | D DALI dimmable | |
| | | DL App bluetooth dimmable | |
| 05 | LIGHT COLOUR | 2 2700K | All |
| | | 3 3000K | |
| | | B3 3000K brilliant | |
| | | M3 3500K meat | |
| | | M5 5300K meat | |
| 06 | CRI | A 80+ | 2700K, 3000K and 4000K |
| | | C 90+ | All (except 3500K and 5300K meat) |
| | | X CRI not specified | 3500K meat and 5300K meat |
| 07 | OPTICS | S1 XQUARE OPTICS 15° | All |
| | | S2 XQUARE OPTICS 20° | |
| | | Q3 XQUARE OPTICS 30° x 30° | |
| | | Q6 XQUARE OPTICS 60° x 60° | |
| | | Q9 XQUARE OPTICS 90° x 90° | |
| | | R1 XQUARE OPTICS 15° x 90° | |
| | | R3 XQUARE OPTICS 30° x 90° | |
| | | N Narrow optics 18° | |
| | | M Medium optics 28° | |
| | | W Wide optics 44° | |
| S2C XQUARE OPTICS ~20° for interchangeable optics | | | |
| XK XQUARE OPTICS ~20° with KIT XQUARE OPTICS Q3, Q6, Q9, R1 and R3 interchangeable | | | |
| 08 | LUMINAIRE | C Textured white | All |
| | | O Textured black | |
| | | H Textured grey | |



i Other customised features under request

BELLEX is manufactured to meet all current regulations and guidelines: UNE 12464, UNE 12193 and EN 60598 under ISO 9001, ISO 14001 and UNE 166002. All figures shown are average values at 25°C ambient temperature.

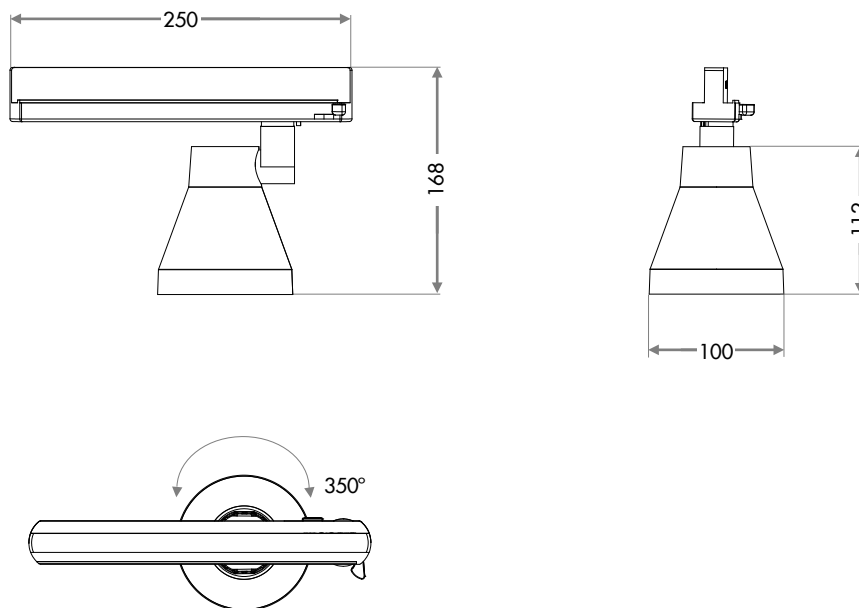
THREE-PHASE TRACK MOUNTING

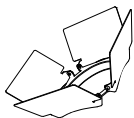

ACCESORIES

| | REF. | DESCRIPTION | AVAILABLE FOR |
|---|----------|---|---------------------------------|
|  | AOV00040 | Anti glare barn doors M100, textured black. | All |
|  | AOV0005 | KIT optics XQUARE OPTICS Q3, Q6, Q9, R1 and R3 interchangeable. | S2C |
| | AOV0018 | Diffuser XQUARE OPTICS ~30° x 30° interchangeable. | S2C |
| | AOV0019 | Diffuser XQUARE OPTICS ~60° x 60° interchangeable. | |
| | AOV0016 | Diffuser XQUARE OPTICS ~90° x 90° interchangeable. | |
| | AOV0020 | Diffuser XQUARE OPTICS ~15° x 90° interchangeable. | |
| | AOV0021 | Diffuser XQUARE OPTICS ~30° x 90° interchangeable. | |
|  | ASV0015 | Programmable wireless control, white, dimmable 4 scenes, wall mounting. | App bluetooth dimmable versions |